

# HS 330 TIMBER/ALUMINIUM LIFT-SLIDING DOOR

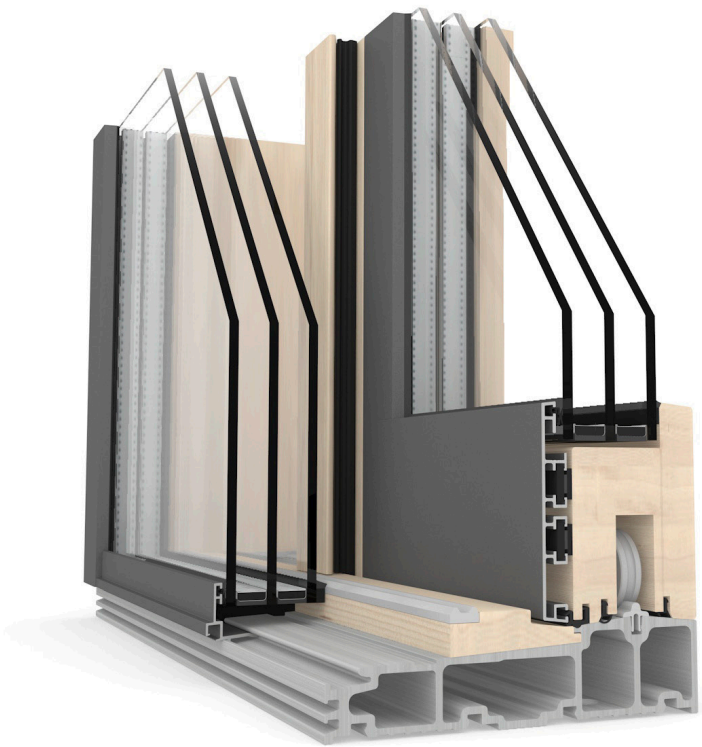

## CHARACTERISTICS

**Thermal insulation**  
(in W/m<sup>2</sup>K)



U<sub>w</sub> as low as 0.73

**Sound reduction**  
(in dB)



up to 40

**Security**



up to RC2

**I-tec Glazing**

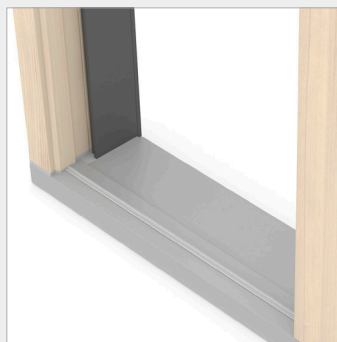
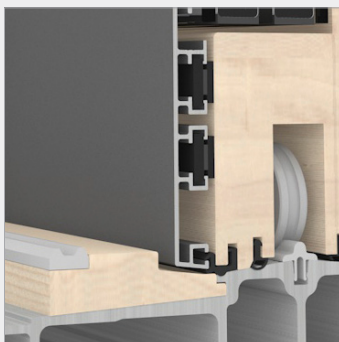

### HS 330

Design your living spaces harmoniously - we can offer you the same timber surfaces and colours for this lift-sliding door as for your timber/aluminium window HF 410. This makes it easier for you to design your personal and coordinated living world. The glass fibre low threshold in the passing area ensures optimum thermal insulation and stability and is covered with anodised aluminium on the outside. The fixed element offers complete glass appearance, it can be rendered into the brickwork on three sides.

## Sections

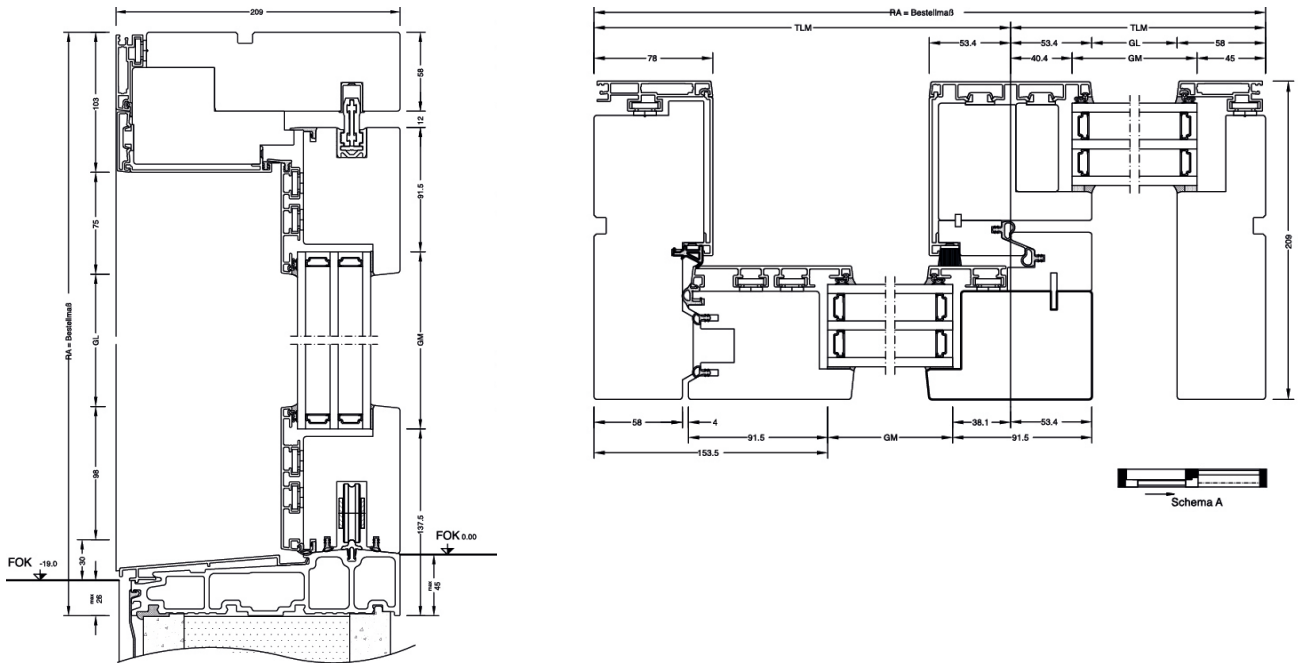

## Construction connections

**ATTENTION!** Depicted drawing is symbolic only. Please observe national fitting guidelines such as ÖNORM B5320 in its respective valid version.

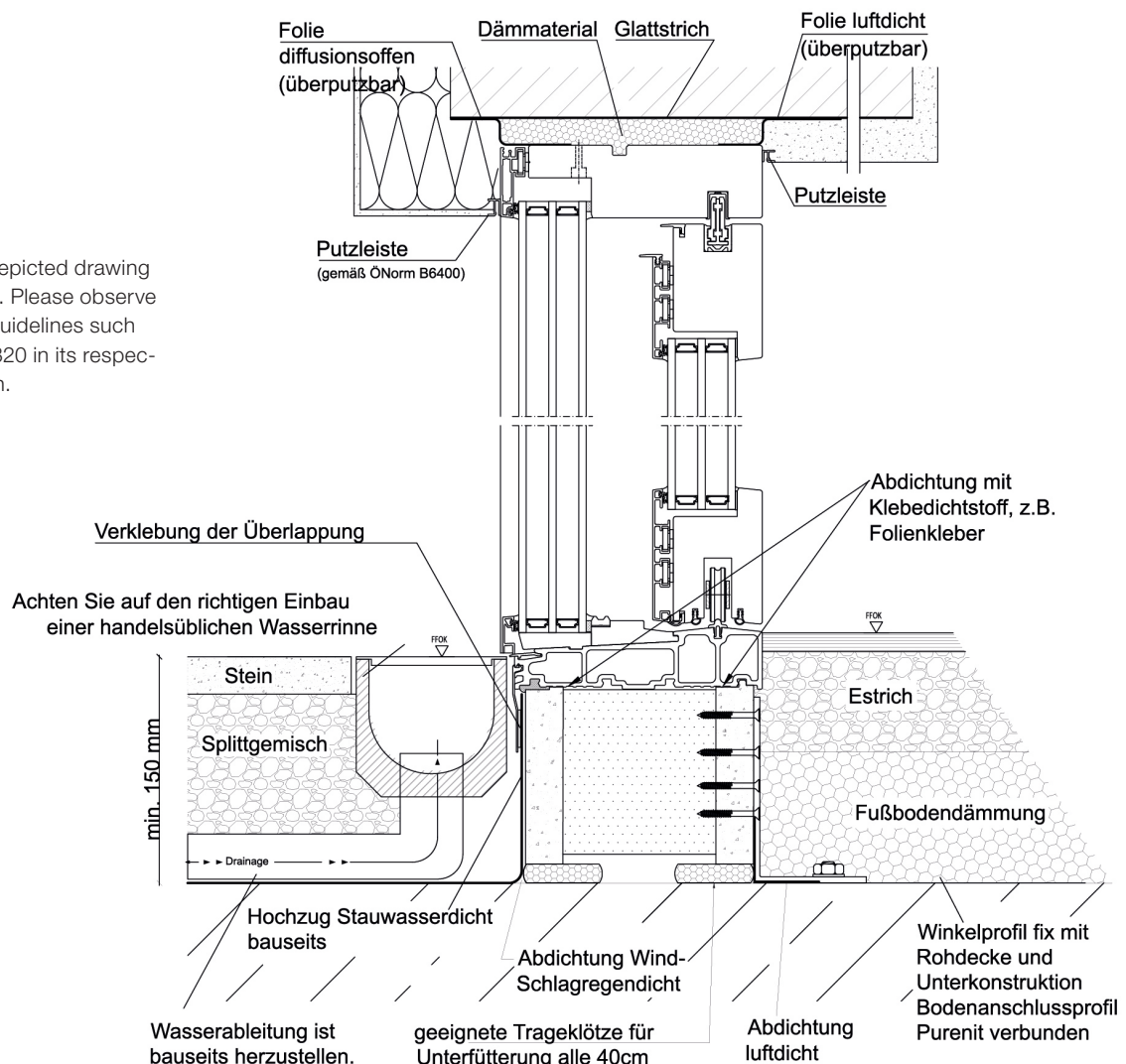

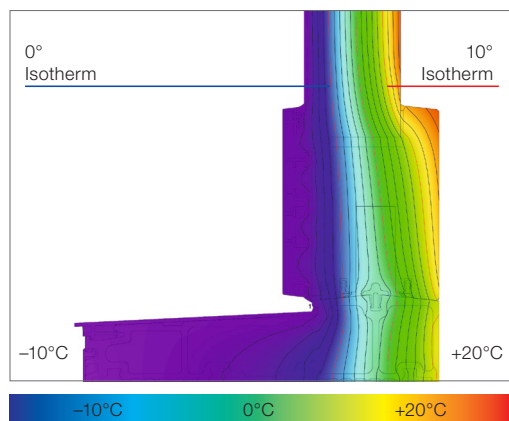

Optimal isotherm gradient to ensure low amounts of condensation

Due to the deep glass position, tremendous construction depth and the directly glued window panes glazing LIGHT ( $U_g = 0.95 \text{ W/m}^2\text{K}$ ) can achieve a  $U_w$  value of  $0.73 \text{ W/m}^2\text{K}$ .

**Technical information**

- Profiling is the same all around
- Inside: all RAL colours; timber types spruce, larch, oak, ash and walnut (Internorm timber colour range). I-tec core setup is used for timber types oak, ash and walnut.
- Anodised, RAL, highly weather-resistant structure, metallic and timber decor colours are available for aluminium outside

**Construction models**

- **Schema A:** sash/ fixed glazing
- **Schema C:** fixed glazing/ sash/ sash/ fixed glazing
- **Schema G:** fixed glazing/ sash/ fixed glazing
- Fixed elements HS330-30
- All glass corners

Schema A

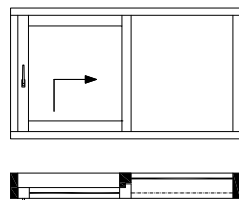

Schema C

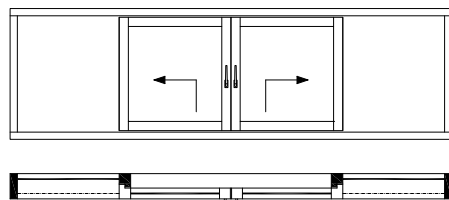

Schema G

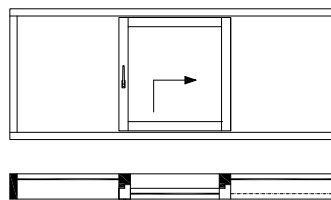

HS330-30

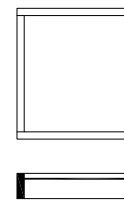

**Values**

System	Glass setup	Glass code	Spacer	Coating	Ug	Uf	Psi	Uw	Thermal cert.	Rw	C	Ctr	Sound cert.
HS330	4bESG/18Ar/4/18Ar/b4ESG	3T6	Iso	light	0.5	1.47	0.039	0.73*	NO	32	-1	-4	YES
			Iso	SolarXPlus	0.5	1.47	0.039	0.73*					
	4bESG/18Ar/4ESG/ 18Ar/b4ESG	3N3	Iso	light	0.5	1.47	0.039	0.73*	NO	33*	-	-	NO
			Iso	SolarXPlus	0.5	1.47	0.039	0.73*					
	6bESG/18Ar/6ESG /18Ar/b6ESG	3FD	Iso	light	0.5	1.47	0.039	0.73	YES	35	-2	-5	YES
			Iso	SolarXPlus	0.5	1.47	0.039	0.81*	NO				
	6bESG/16Ar/b6ESG	2UF	Alu	light	1.1	1.57	0.077	1.3	YES	33	-1	-4	YES
			Iso	light	1.1	1.57	0.044	1.3					
	8bESG/16Ar/6ESG/ 18Ar/b6ESG	3FG	Iso	light	0.5	1.47	0.039	0.73*	NO	38	-2	-5	YES
			Iso										
44.2b/18Ar/5/16Ar/ b6ESG	3F8	Iso	light	0.5	1.47	0.039	0.73*	NO	40	-2	-6	YES	
		Iso	SolarXPlus	0.5	1.47	0.039	0.73*						

Certificates were calculated/tested with coating light